



HUDSON BAY INSERT
DIRECT VENT GAS INSERT

QUADRA-FIRE[®]
NOTHING BURNS LIKE A QUAD

HUDSON BAY INSERT



Dimensions

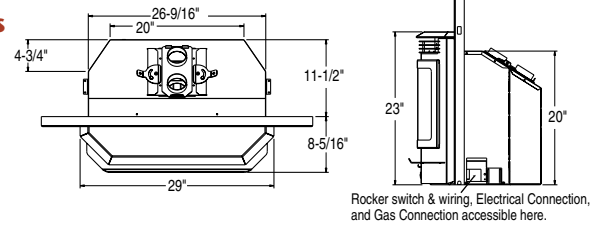

MINIMUM FIREBOX OPENING

Height Front: 20-1/4" Rear: 14-1/2"
 Width Front: 26-1/2" Rear: 20"
 Depth Top: 13" Bottom: 13"

PANEL SIZES

Standard 28" x 40"
 Large 33" x 46"

Rocker switch & wiring, Electrical Connection, and Gas Connection accessible here.

Clearances

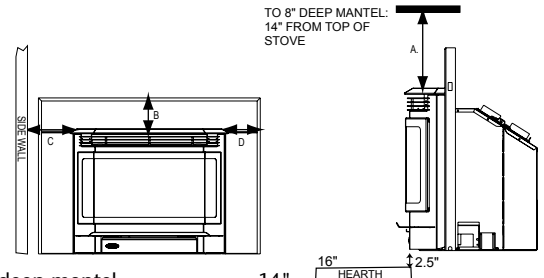

- A Top plate to 8" deep mantel 14"
- B Top plate to 3/4" trim above 11"
- C Top plate to side wall 12"
- D Top plate to 3/4" trim at sides 7"

Technical & Performance Data

Width 29"	Flue size 3" co-linear
Height 23"	Standing pilot ignition Yes
Depth 19-13/16"	Mobile home approved Yes
Shipping weight 172 lbs.	Bedroom approved Yes

Heating capacity* Up to 2,000 sq. ft.*
Btu/Hour Input NG 28,000 – 42,000
Btu/Hour Input LP 31,000 – 40,500
Thermal efficiency** 83.56% NG/85.39% LP
AFUE efficiency** 66.16% NG/68.61% LP
Convection blower 160 cfm

Quadra-Fire offers a Limited Lifetime Warranty on our gas heating appliances to the original purchaser for the lifetime of the appliance, to be free from defects in material and workmanship. See your authorized Quadra-Fire dealer for details.



IMPORTANT - READ BEFORE YOU INSTALL!

Refer to the Owner/Installation Manual for complete clearance requirements and specifications. The images and descriptions in this brochure are provided to assist you in product selection only.
 *Heating capacity rating is to be used as a guideline only. Actual performance may differ slightly due to climate, building construction and condition, amount and quality of insulation, location of the heater, and air movement in the room.
 **Canadian EnerGuide efficiency: P.4.1-02 71.41% NG/74.45% LP.

Quadra-Fire is a registered trademark of Hearth & Home Technologies Inc. Product specifications and pricing subject to change without notice. The Quadra-Fire Hudson Bay Insert direct vent gas appliance listed to ANSI standard Z21.88a-2000/CSA 2.33a-M00 Vented Gas Fireplace Heaters and applicable sections of UL307b Gas Burning Heating Appliances for Manufactured Homes and Recreational Vehicles, CAN/CGA 2.17-M91 "Gas Fired Appliances for Use at High Altitude," by OMNI-Test Laboratories, Inc., Beaverton, OR.

Elegant contemporary design and unbelievably realistic flame are the hallmarks of the Hudson Bay Insert from Quadra-Fire. Clean lines highlighted with optional door crowns and grilles in your choice of gold or satin nickel complement the décor of any room. The exclusive TrueGlow burner and logs create the most awesome show of flame ever, all displayed through a huge bay glass window. Art combines with performance and efficiency in the Hudson Bay Insert.

The TrueGlow Burner, an exclusive from Quadra-Fire, sets a new standard for realism. The ceramic burner is molded from real wood pieces and coals. Flames rise from gas ports distributed throughout the glowing coal bed and lower logs, producing an incredibly active and varied fire. No need to hide the burner anymore—the TrueGlow burner proudly takes center stage, with an appearance that is phenomenal whether it's burning or not.



Standard Features

- Expansive bay window
- TrueGlow burner
- PyroGlo "real wood" logs
- Black door/louvered grille
- Herringbone ceramic refractory interior
- Durable steel construction
- Tube heat exchanger
- Automatic, 160-cfm, variable speed blower
- Manufactured home approved
- Bedroom approved
- Limited Lifetime Warranty

Options

- Door crown in gold or satin nickel
- Louvered grille in gold or satin nickel
- Two panel sizes with gold or satin nickel trim
- Thermostatic remote controls
- Wall thermostat

QUADRA-FIRE
 NOTHING BURNS LIKE A QUAD

1445 North Highway, Colville, WA 99114
 www.quadrafire.com • 800-926-4356
 QDF-1011U-1107

Available From: